

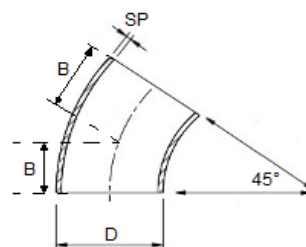

CURVE SALDATE

PRODOTTO	CURVE
MATERIALE	ACCIAIO INOX
TIPOLOGIA	AISI 304/304L - AISI 316/316L EN 1.4301/1.4307 - EN 1.4401/1.4404
NORMATIVA	EN 10253

CURVE

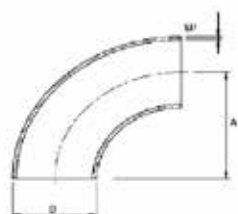

MISURE ISO

Diam nominale	Diam pollici	Diam esterno	Raggio		SP
			90° A	45° B	
200	8"	219,1	305	127	4-10
250	10"	273,0	381	159	2-10
300	12"	323,9	457	190	3-10
350	14"	355,6	533	222	3-10
400	16"	406,4	610	254	3-10
450	18"	457	686	286	3-10
500	20"	508,0	762	318	3-10
600	24"	610	914	381	3-10

* Le informazioni riportate in tabella sono indicative e non vincolanti.

* Le dimensioni sono espresse in mm.